

# Gulet Bonaventura



Bonaventura is uniquely designed yacht that evokes a bygone era. From her elegant hull to her handcrafted mahogany interiors and furniture, she has the grace, class and elegance of a traditional yacht, yet has the engineering and amenities of a modern one.

The main saloon combines a dining area with an elegant bar and lounge seating area. The wooden floors, stylish furniture and decent decorations create a comfortable and relaxing feeling. The saloon includes LED TV and DVD player. The sunbathing mattresses spread on deck will give you the perfect opportunity to sunbathe and relax while cruising or enjoying a emerald bays.

## PRICE LIST (2016)

Period:	01.01. – 21.05. 01.10. – 31.12.	21.05. –11.06. 17.09. – 01.10.	11.06. - 17.09.
Price (€):	<b>15.500</b>	<b>16.200</b>	<b>17.300</b>

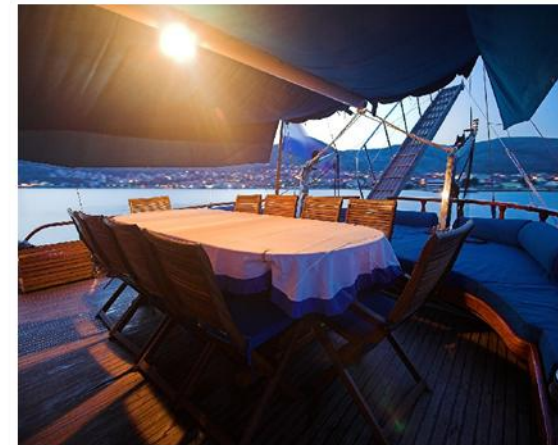

### INCLUDED IN THE PRICE:

- shipboard accommodation,
- permits, insurance for all guests (while on the boat),
- crew, all equipment on board (except jet ski),
- tender with outboard engine,
- linens and towels,
- fuel for main engine,
- Gouvernment tax/Personal tax/Port-Harbour taxes,
- wireless for 5 computers.

### EXCLUDED:

- food,
- beverages,
- transfers to or from the yacht/hotel/airport,
- shore excursions,
- adverse activities (scuba diving, big game fishing, rafting, jet ski),
- guided tours,
- National park entrances,
- gratuities/tips for the crew,
- marina fees.





#### FOOD OPTIONS:

- Half board (breakfast and lunch): 630 € per person for 1 week. (OBLIGATE)
- Full board (breakfast, lunch and dinner): 710 € per person for 1 week.
  - \*Children under 4 are free of charge on food, children 4 – 7 years old get 50% discount

**Beverages on yacht bar only!**

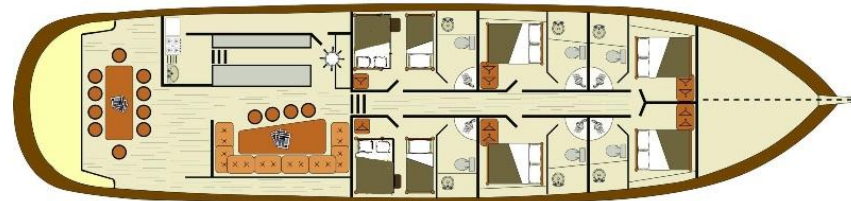

#### ACCOMMODATION:

Gulet Bonaventura is capable to host up to 12+2 clients. The cabins are 2 double bed plus single bunk in each bed and 4 double bed cabins, each air conditioned and with en suite toilets.

### [Gulet Bonaventura - Photos](#)

#### PAYMENT CONDITIONS:

- 50% ADVANCE payment - upon reservation.
- 50% BALANCE payment - 5 weeks before charter period.

**CHECK-IN:** Saturday - 16:00 h

**CHECK-OUT:** Saturday - 09:00 h

