

Gulet Enigma

Gulet Enigma offers accommodation in 7 comfortable guest cabins, each with a toilet with shower and air conditioning. The guests have at their disposal also a spacious salon with bar and the sun deck.

We offer you to travel onboard from Split, Trogir or Dubrovnik, 14 passengers completely equipped for comfortable rest. Enigma, traditional gulet it is constructed in Turkey in port Bodrum according to the Croatian standards Croatian Shipping Registry (CSR). Warm and professional command guarantees to you unforgettable rest on Adriatic coast.

PRICE LIST (2016)

Period:	30.04. - 04.06. 03.09. - 29.10.	04.06. - 11.06. 27.08. - 03.09.	11.06. - 02.07.	02.07. - 16.07.	16.07. - 27.08.
Price (€):	10.000	11.000	12.000	12.700	13.200

INCLUDED IN THE PRICE:

- rental with four crew members,
- tourist taxes,
- bed and table linen,
- air condition max 4h working hours per day,
- active sailing max 4 works per day,
- personel services,
- bed linen, table linen and device,
- using beach towels,
- TSD, DVD, Internet.

EXCLUDED:

- food and drinks,
- port fee and charges,
- excursions and entrance tickets to the National parks,
- parking in ports,
- other activities.





FOOD OPTIONS:

- Half board: 280 € pax/week (breakfast + lunch).
- Full board: 380 € pax/week (breakfast + lunch + dinner).

Beverages on yacht bar only!

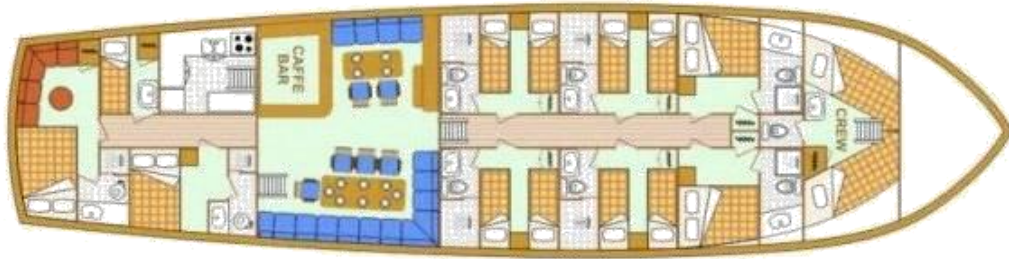

ACCOMMODATION:

- 4 double bed cabins
- 3 twin bed cabins

[Gulet Enigma - photos](#)

PAYMENT CONDITIONS:

- 50% ADVANCE payment - upon reservation.
- 50% BALANCE payment - 5 weeks before charter period.

CHECK-IN: Saturday - 16:00 h

CHECK-OUT: Saturday - 09:00 h

