

Gulet Morning Star



Morning Star built in 2008, with its luxury really leaves without breath. Gulet is 27 meters long and its six cabins can accommodate up to 14 people, while additional comfort is offered by interior made of mahogany, air conditioning in all cabins and plasma TVs. On the front deck there are deck chairs where you can relax, sunbathe and enjoy the beautiful view of the sea, while the evenings are reserved for a stay in a beautifully furnished lounge bar, where all meals are served, and to walk and absorb the atmosphere of beautiful towns and the coast islands. Departure ports: Šibenik, Primošten, Dubrovnik.

PRICE LIST (2016)

Period:	01.01. – 18.06. 17.09. – 31.12.	18.06. – 09.07. 27.08. – 17.10.	09.07. –27.08.
Price (€):	13.970	14.950	17.500

INCLUDED IN THE PRICE:

- accommodation on the yacht,
- 4 crew members,
- wages and food for the crew,
- Croatian VAT and sojourn taxes,
- fuel for main engines ut to 4 hours cruising per day,
- fuel for 12 hours/day of generator use,
- complete linen and towels,
- yacht insurance and yacht cleaning,
- tender with outboard engine,
- use of leisure equipment on board (canoe, snorkeling equipment, canoe, water ski),
- Wi-Fi internet access.

EXCLUDED:

- food and drinks,
- port and marina fee,
- tickets for national parks,
- crew tips.





FOOD OPTIONS:

- Half board: 300 €/person/week (breakfast and lunch) - obligatory
- Full board: 430 €/person/week (breakfast, lunch and dinner)

BEVERAGE OPTIONS:

- All inclusive domestic package (beer, wine, water, soft drinks, coffee, tea and all domestic alcoholic drinks): 150 €/person/week.
- Non alcoholic package: 80 €/person/week.
- Beverages on yacht bar only.
- Service cost for beverages supplied by clients: 600 €/week/booking.

EXTRA COST:

- Extra hours of engine is 75 €/h, extra hours of generator is 20 €/h (air conditioning).
- Extra charge One way is 1000 €.
- Extra meal (dinner) is optional on board 35 €/meal per person.
- *Children discount: Up to 2 years free, from 2 to 12 years 50 % reduction.

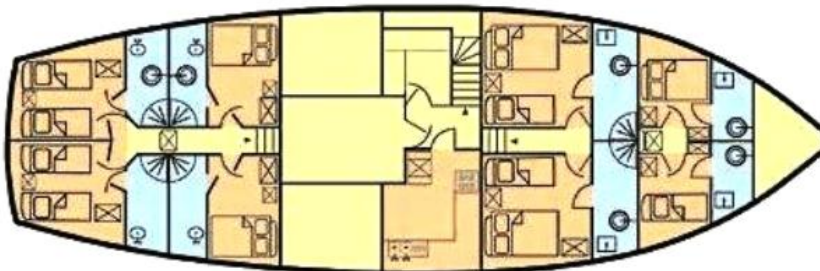

ACCOMMODATION:

- 4 double bed cabins
- 2 twin bed cabins

[Gulet Morning Star - photos](#)

PAYMENT CONDITIONS:

- 50% ADVANCE payment - upon reservation.
- 50% BALANCE payment - 5 weeks before charter period.

CHECK-IN: Saturday - 16:00 h

CHECK-OUT: Saturday - 09:00 h

